

SPECIFICATIONS

2P3T Slide switch

RATINGS:

16A 125VAC, 8A 250VAC [UL, cUL]
 13A 125VAC, 6.5A 250VAC [UL, cUL]

8A 250VAC [TUV]

CONTACT RESISTANCE:
 35mΩ Max.

INSULATION RESISTANCE:
 100MΩ at 500VDC

WITHSTAND VOLTAGE:
 1,500VAC For 1 Minute

ELECTRICAL LIFE:
 >10,000 Cycles

MATERIALS

CASE:
 Steel

TERMINAL BASE:
 PC board

KNOB:
 Polyoxymethylene

CONTACTS:
 Silver-Nickel Alloy

TERMINALS:
 Silver Plated Copper

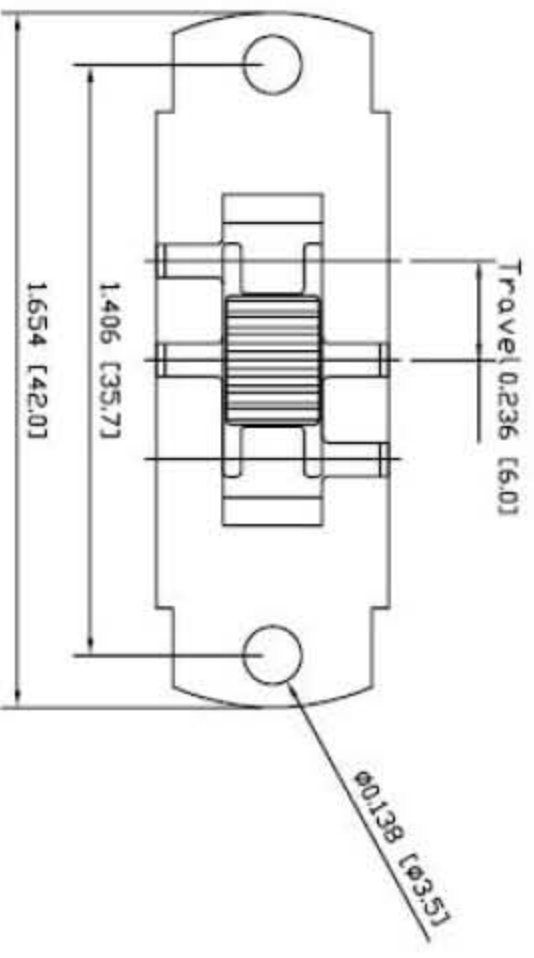
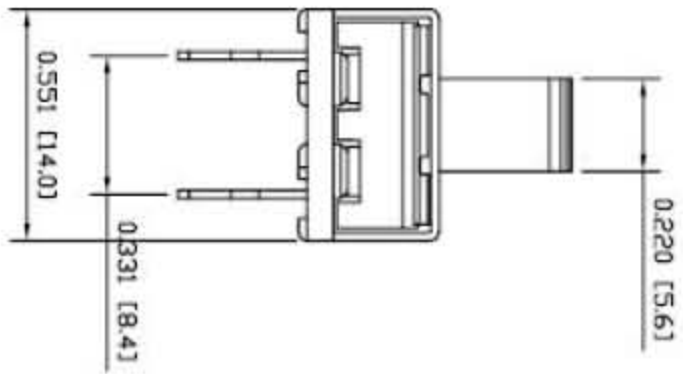
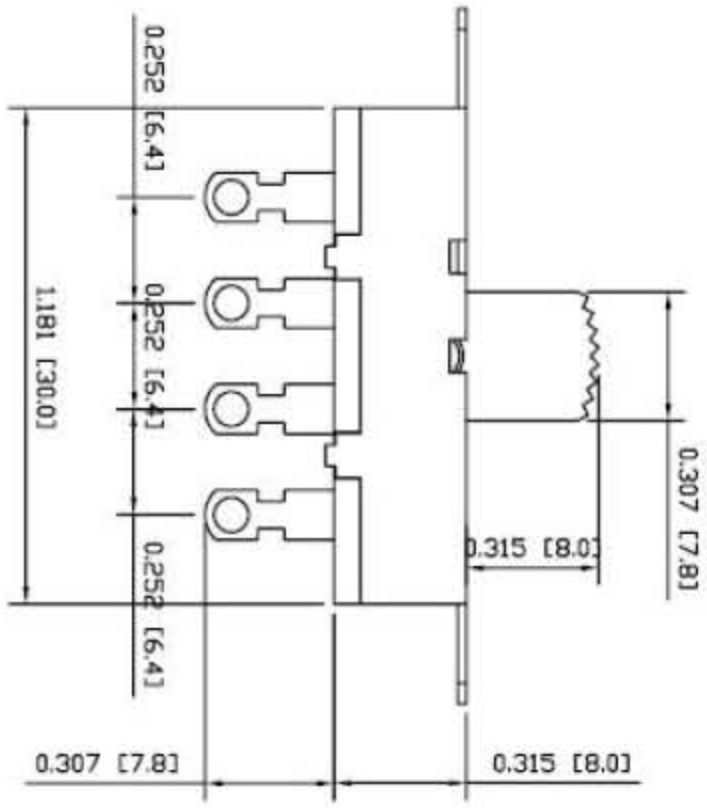

Series	XN1-	Function	23	Rating	13	Case	N	Terminal	V	Knob	W
			13 - 1P3T		13 - 13A 125VAC		N Case		S - Solder		E
			23 - 2P3T		16 - 16A 125VAC		Q Case		T - PC		D
											H

Knob Options:

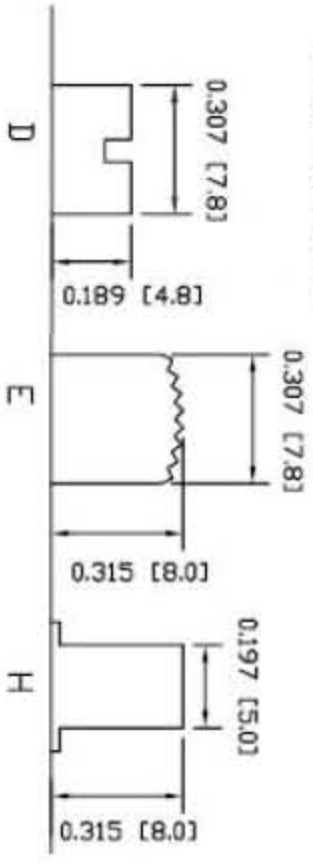

Case Options:

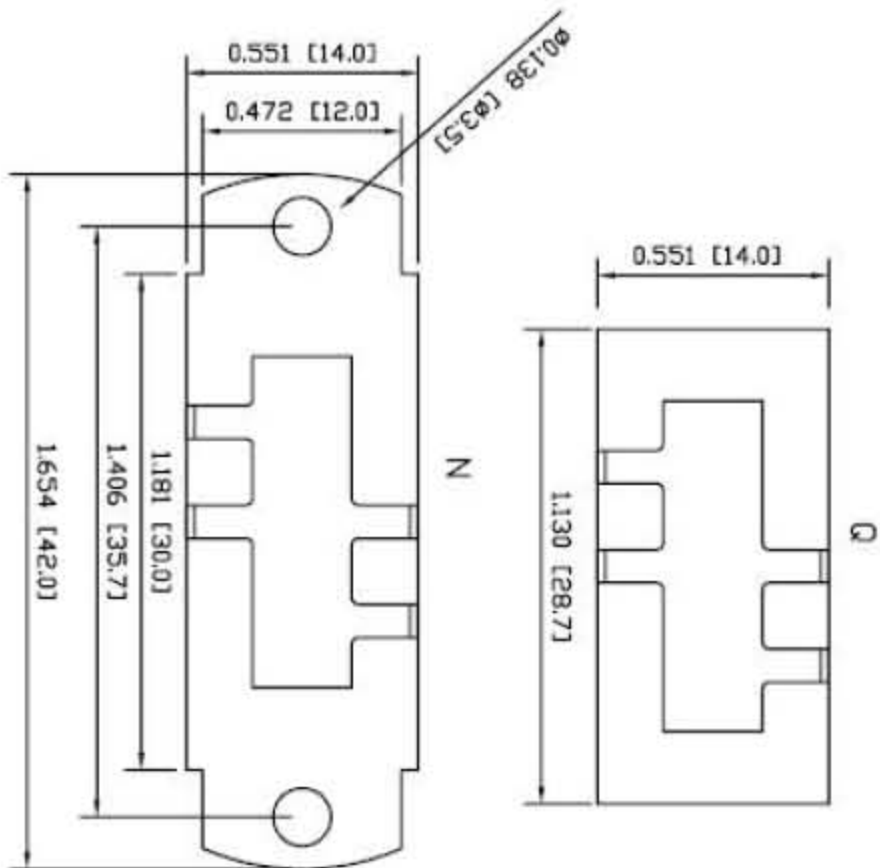

Terminal Option:

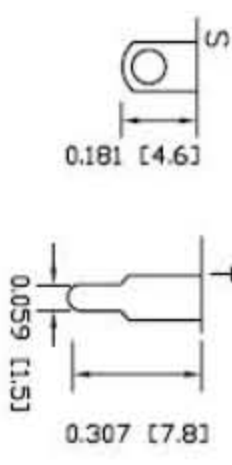

PHASEDA LLC

XN1-23 series

SPECIFICATION SUBJECT TO CHANGE WITHOUT PRIOR NOTICE

DIMENSIONS ARE IN INCHES [MILLIMETERS]

TOLERANCES: DEC. X±0.2

DRAWING NOT TO SCALE

DATE: JAN 2007

8

7

6

5

4

3

2

1

D

C

B

A