

8 7 6 5 4 3 2 1

SPECIFICATIONS

RATINGS:
 16A 125VAC 105°C UL,cUL
 1/2HP 125VAC, 3/4HP 250VAC UL,cUL
 16(4)A 250V~ T125 1E4 VDE
 10(4)A 250V~ T125 SE4 VDE

CONTACT RESISTANCE:
 35mΩ Max 50VDC

INSULATION RESISTANCE:
 100MΩ at 500VDC Min.

WITHSTAND VOLTAGE:
 1,500VAC For 1 Minute

ELECTRICAL LIFE:
 >10,000 Cycles

MATERIALS

BODY:
 PA66

ACTUATOR:
 PA66, PC for illuminated rocker

CONTACT:
 Silver Alloy

TERMINALS:
 Silver Plated Copper

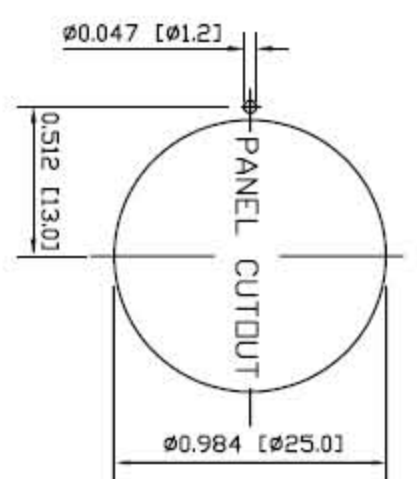
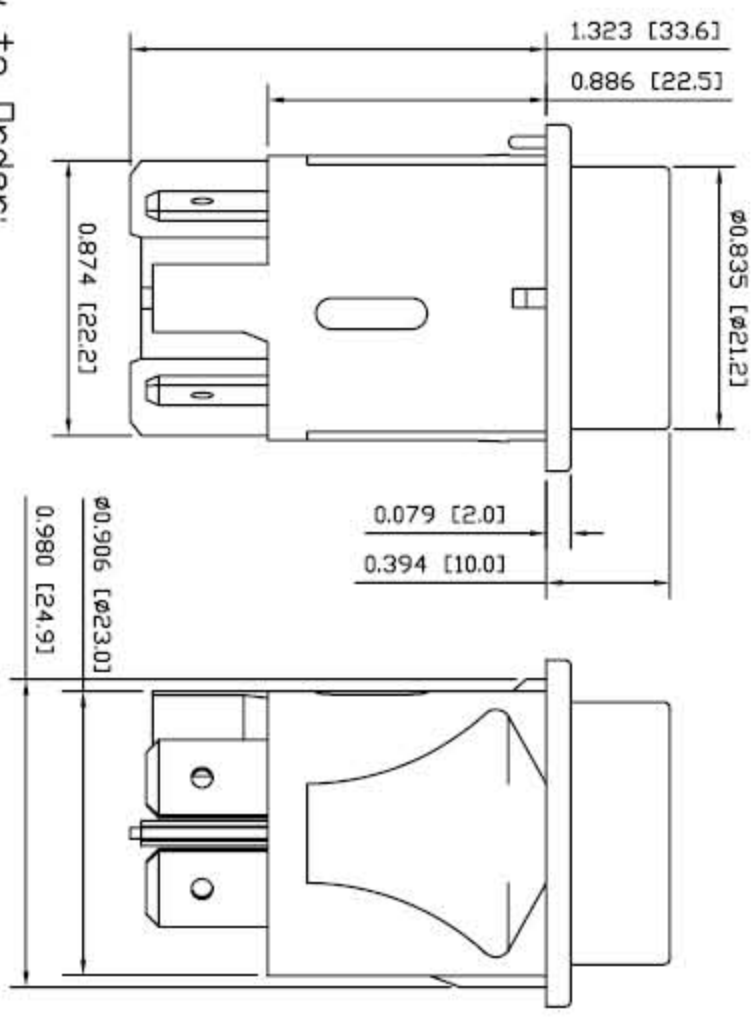
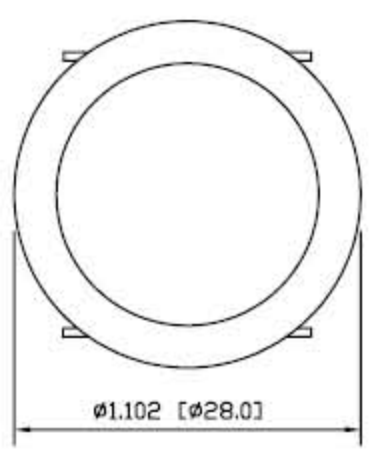

PVC Cap

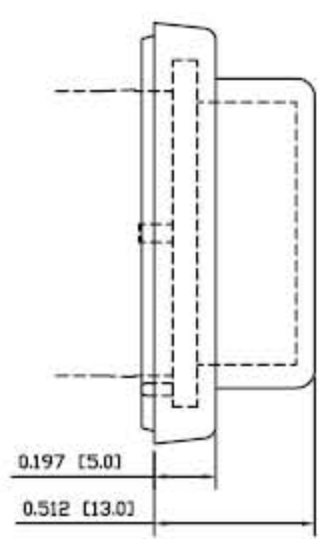

How to Order:

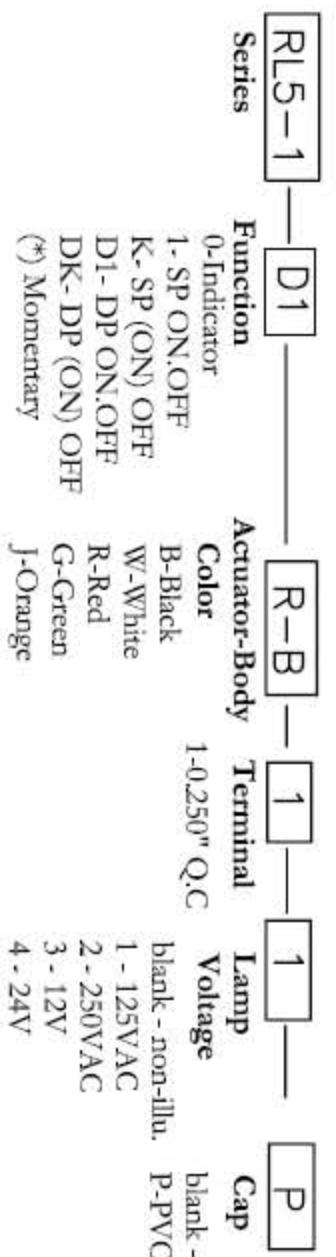

Terminal Option:

1. 0.250" Q.C

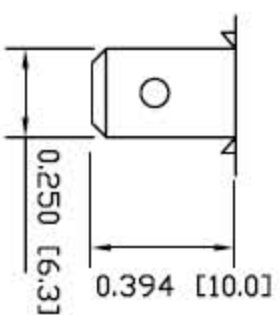

PHASEDA LLC

RL5-1 series

SPECIFICATION SUBJECT TO CHANGE WITHOUT PRIOR NOTICE DIMENSIONS ARE IN INCHES [MILLIMETERS] TOLERANCES: DEC .X±0.2 DRAWING NOT TO SCALE DATE: JAN 2007

8 7 6 5 4 3 2 1

D

C

B

A