

8 7 6 5 4 3 2 1

**SPECIFICATIONS**

Slide switch

**RATINGS:**  
3(3)A 250V~ [VDE]

**CONTACT RESISTANCE:**  
35mΩ Max.

**INSULATION RESISTANCE:**  
100MΩ at 500VDC

**WITHSTAND VOLTAGE:**  
1,500VAC For 1 Minute

**ELECTRICAL LIFE:**  
>10,000 Cycles

**ELECTRICAL LIFE:**  
>10,000 Cycles

**MATERIALS**

**CASE:**  
Nylon

**KNOB:**  
Nylon

**CONTACTS:**  
Silver-Nickel Alloy

**TERMINALS:**  
Silver Plated Copper

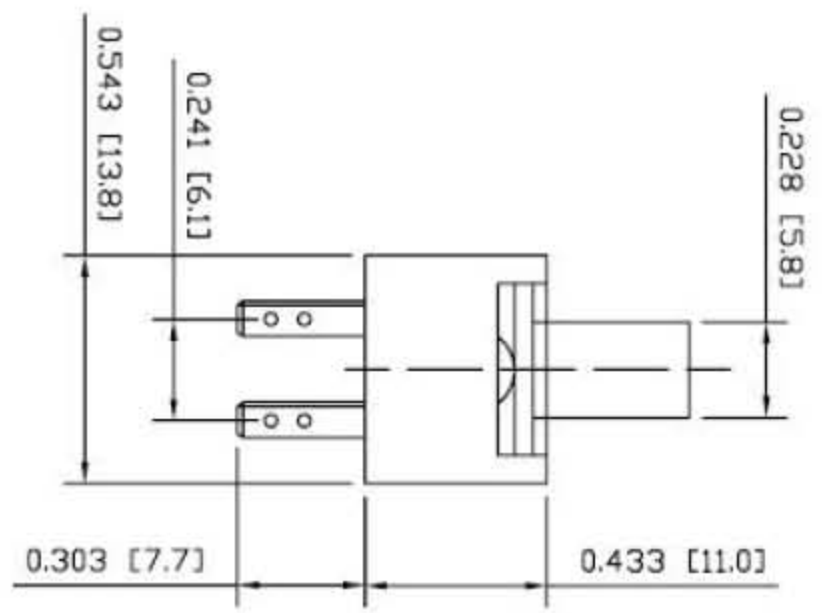
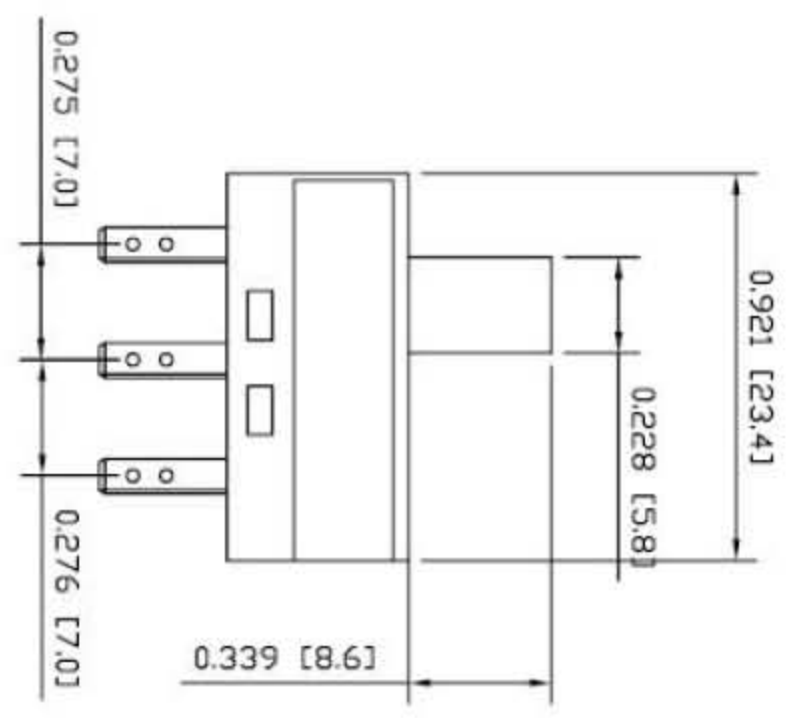

**How to Order:**

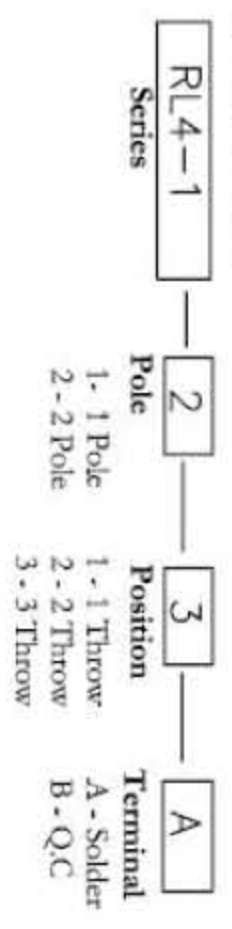

**Terminal Options:**

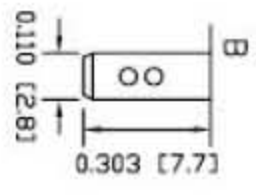
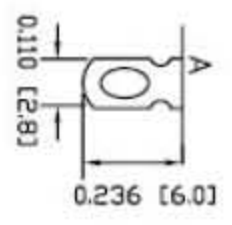

PHASEDA LLC

**RL4-1 series**

SPECIFICATION SUBJECT TO CHANGE WITHOUT PRIOR NOTICE | DIMENSIONS ARE IN INCHES [MILLIMETERS] | TOLERANCES: DEC. X±0.2 | DRAWING NOT TO SCALE | DATE: JAN 2007

8 7 6 5 4 3 2 1

D

C

B

A