

8 7 6 5 4 3 2 1

**A** SPECIFICATIONS

RATINGS:  
 20A 125VAC, 12A 250VAC UL, cUL  
 2HP 125/250VAC, 85°C UL, cUL  
 1.5HP 125/250VAC (for momentary)  
 8.5A 250VAC 5E4 TUV

ELECTRICAL LIFE:  
 10,000 Cycles Min.

CONTACT RESISTANCE:  
 30mΩ at 50VDC

INSULATION RESISTANCE:  
 800MΩ at 500VDC

WITHSTAND VOLTAGE:  
 1,500VAC for 1 Minute

**B** MATERIALS

BODY:  
 Phenolic, UL 94V-0

ACTUATOR:  
 Chrome plated Brass

CONTACTS:  
 Silver Alloy

TERMINALS:  
 Silver Plated Brass

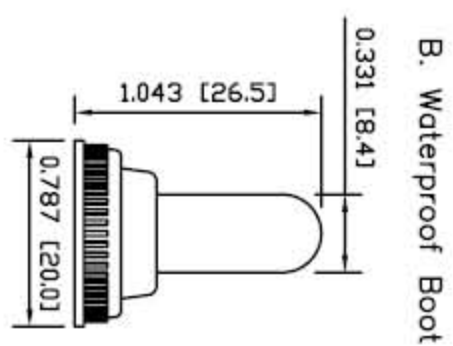
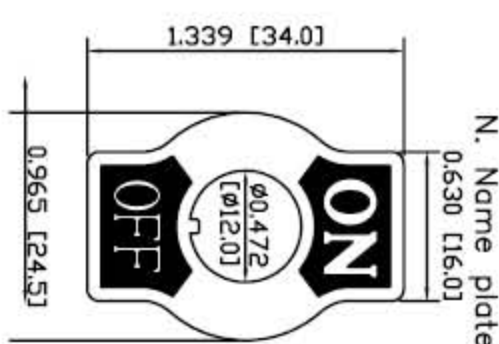
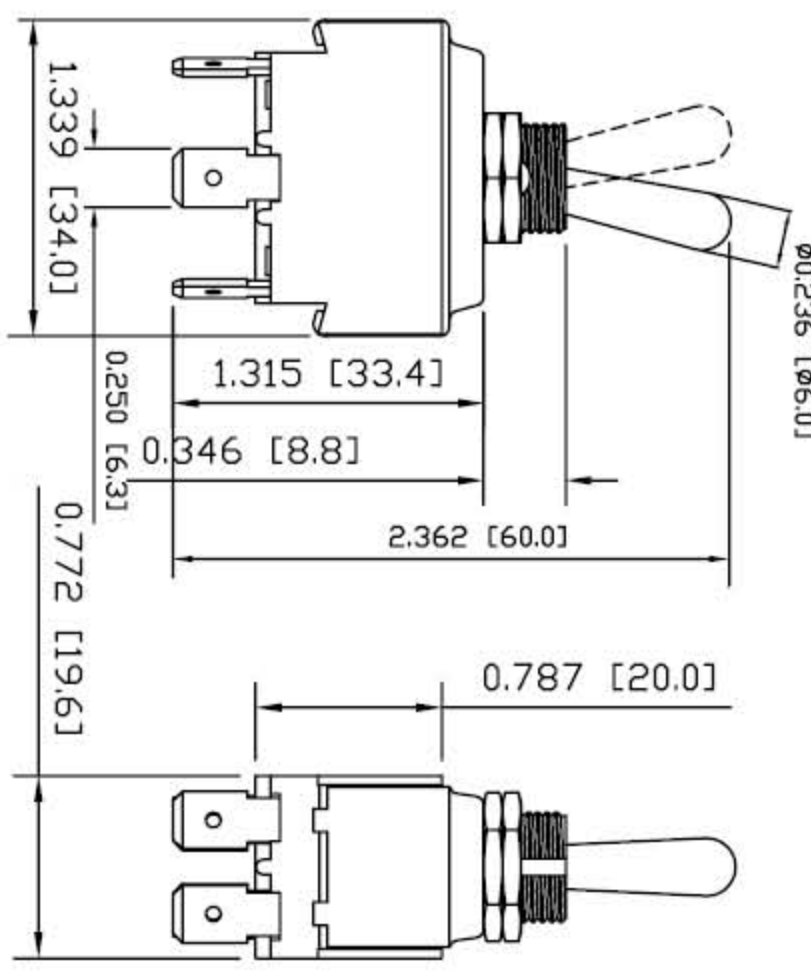
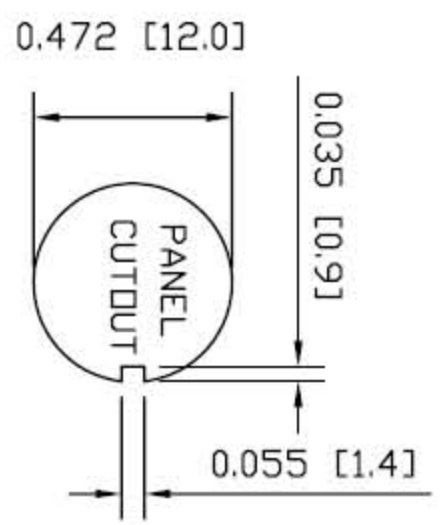
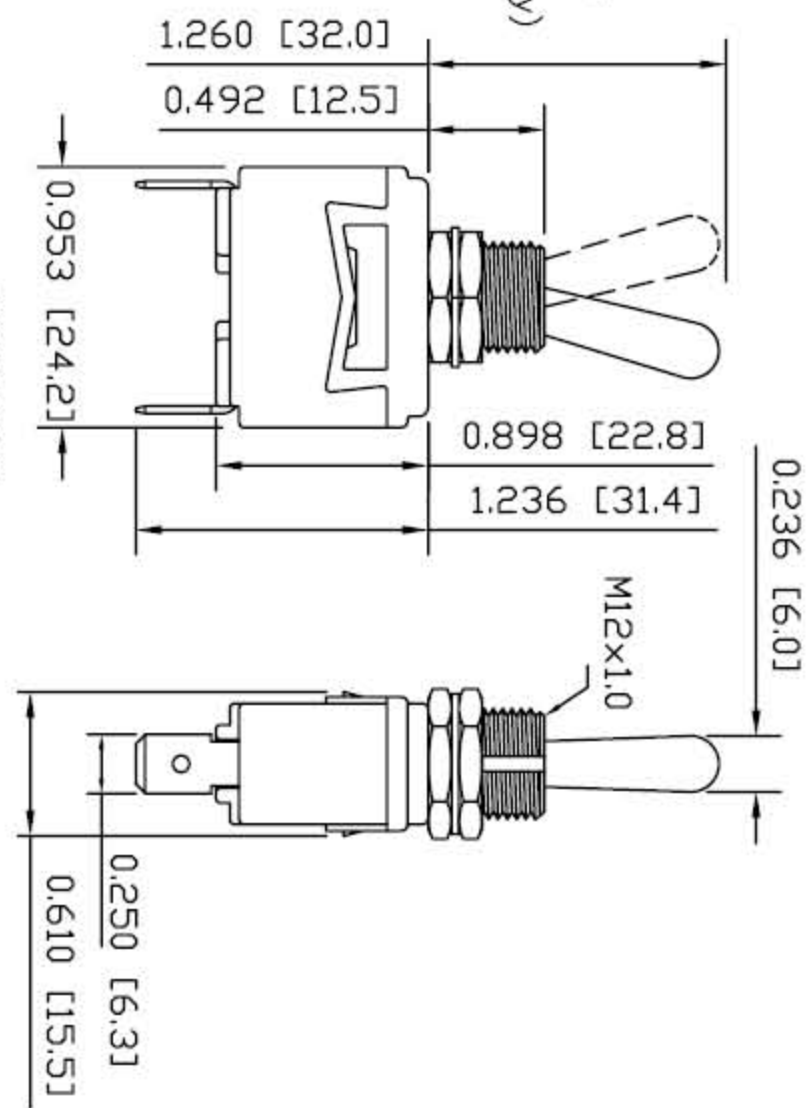

**C** How to Order:

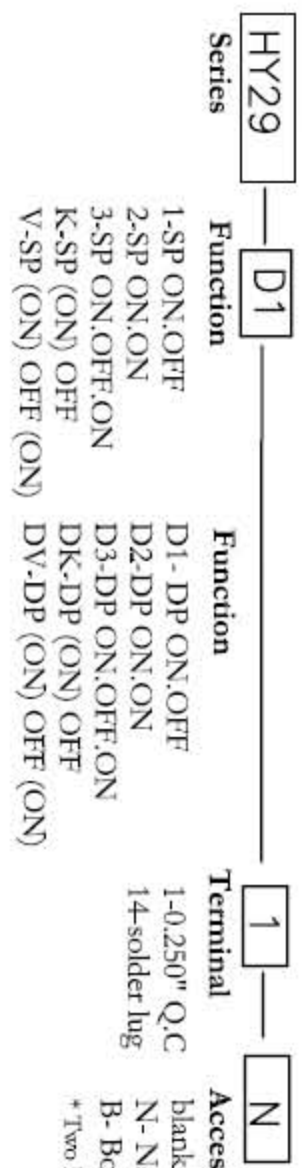

- | Function           | Terminal            | Accessories   |
|--------------------|---------------------|---------------|
| 1-SP ON/OFF        | D1-DP ON/OFF        | blank - none  |
| 2-SP ON/ON         | D2-DP ON/ON         | N- Name plate |
| 3-SP ON/OFF/ON     | D3-DP ON/OFF/ON     | B- Boot       |
| K-SP (ON) OFF      | DK-DP (ON) OFF      |               |
| V-SP (ON) OFF (ON) | DV-DP (ON) OFF (ON) |               |



PHASEDA LLC

HY29 series

SPECIFICATION SUBJECT TO CHANGE WITHOUT PRIOR NOTICE DIMENSIONS ARE IN INCHES [MILLIMETERS] TOLERANCES: DEC .X±0.2 DRAWING NOT TO SCALE DATE: JAN 2007

8 7 6 5 4 3 2 1

**A**

**B**

**C**

**D**

**Terminal Option:**

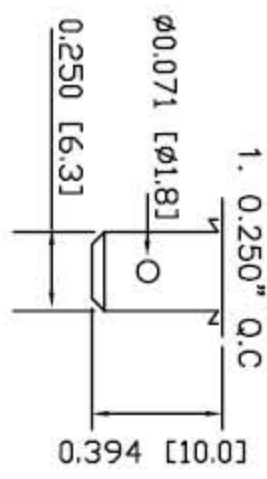

**14. solder lug**

